

Basic Report

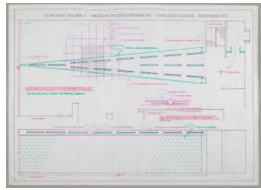

Primary Maker: Robert Irwin

Nationality: American
Floor Plan: Scrim Light Volume V - Museum of Contemporary Art, Chicago, Illinois, November 1975

Date: November 1975

Credit Line: Gift of Ira and Carol Licht, WCMA Instructional Collection

Medium: ink on paper

Dimensions: image: 22 × 31 in. (55.9 × 78.7 cm)
sheet: 24 × 33 1/2 in. (61 × 85.1 cm)

Classification: Instruction

Object number: A.62.4.A

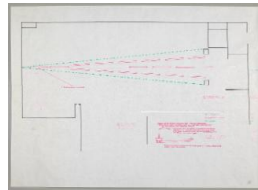

Primary Maker: Robert Irwin

Nationality: American
Floor Plan: Triangular Scrim--Ambient Light Volume, Museum of Contemporary Art, Chicago, Illinois

Date: 1975

Credit Line: Gift of Ira and Carol Licht, WCMA Instructional Collection

Medium: ink on paper

Dimensions: image: 22 × 31 in. (55.9 × 78.7 cm)
sheet: 24 × 33 1/2 in. (61 × 85.1 cm)

Classification: Instruction

Object number: A.62.4.B

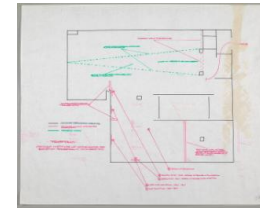

Primary Maker: Robert Irwin

Nationality: American
Floor Plan: Triangular Scrim--Ambient Light Volume, Museum of Contemporary Art, Chicago, Illinois

Date: 1975

Credit Line: Gift of Ira and Carol Licht, WCMA Instructional Collection

Medium: ink on paper

Dimensions: image: 22 × 31 in. (55.9 × 78.7 cm)
sheet: 24 × 33 1/2 in. (61 × 85.1 cm)

Classification: Instruction

Object number: A.62.4.C

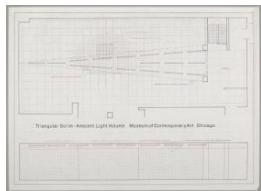

Primary Maker: Robert Irwin

Nationality: American
Floor Plan: Triangular Scrim--Ambient Light Volume, Museum of Contemporary Art, Chicago, Illinois

Date: 1975

Credit Line: Gift of Ira and Carol Licht, WCMA Instructional Collection

Medium: ink and pencil on paper

Dimensions: image: 22 × 31 in. (55.9 × 78.7 cm)
sheet: 24 × 33 1/2 in. (61 × 85.1 cm)

Classification: Instruction

Object number: A.62.4.D

