

Basic Detail Report

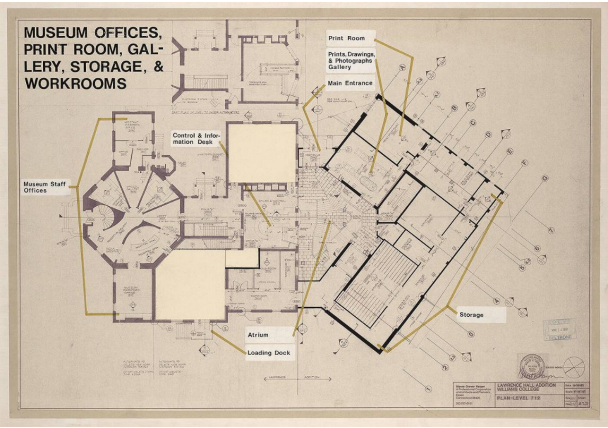

Lawrence Hall Addition, Level 712: Museum Offices, Print Room, Gallery, Storage, & Workrooms

Date
1981

Primary Maker
Moore, Grover & Harper

Medium
print on paper

Description
mounted to foam core

Dimensions
image: 24 1/4 x 35 5/16 in. (61.6 x 89.7 cm) Overall: 27 1/4 x 38 3/8 in. (69.2 x 97.4 cm)